

# CONTRIVERS

---

PROJECT MANAGEMENT CONSULTANTS

## COMPANY PROFILE





# About Our Company

---

Contrivers was founded in 2018 with vision to provide reliable, trustworthy and effective project management solutions for construction projects.

Backed by 16 years of prior experience in managing a diverse portfolio of high end developments, we bring hands on expertise across all phases of a project from initiation to successful hand over.



# Our Approach

Rooted in quality, efficiency, and commitment to timelines and budgets, we have successfully delivered a range of projects in collaboration with renowned consultants in Pakistan and abroad, including:

- |    |                             |    |                       |
|----|-----------------------------|----|-----------------------|
| 01 | Commercial Office Buildings | 05 | Universities          |
| 02 | Hotels                      | 06 | Factory Units         |
| 03 | Shopping Malls              | 07 | Apartment Buildings   |
| 04 | Hospitals                   | 08 | Mixed Used Facilities |



# Our Mission

---

At Contrivers, we work closely with our clients, driven by passion and professionalism to exceed expectations at every step. As the construction industry evolves, Contrivers is fully equipped and enthusiastic to take on both vertical and horizontal construction challenges adding more milestones to our growing legacy.





# Meet Our CEO

---

Muhammad Waqas Zafar, our CEO began his journey in Construction industry from 2002 where he has worked in Project Management Consultant companies and with Employers on multifarious high-end projects till 2018.

He has 23 years of experience in managing large-scale real estate developments. His leadership and meticulous attention to detail have been instrumental in the successful completion of numerous high-profile projects. His portfolio boasts leading as a Project Management Consultant on luxury, high-end developments including large scale purpose built residential and retail communities, residential apartments, office towers, leisure facilities, shopping centers, hunting resorts, 5-star hotels, hospitals, purpose-built entertainment centers, factories and industries.

The heart of his success, is his education, a Masters in Business Administration combined with Civil Engineering which best places him to not just consider the construction, but also applying his financial skills to maximize the potential of any project.



# Our Services

---

- Project Planning & Strategy
- Coordination with Authorities
- Hiring of Design Consultants
- Planning & Monitoring of Design Deliverables
- Documentation for Submission to Authorities
- Tender & Bidding Process
- Hiring of Contractors & Vendors
- Design Management
- Contractors & Vendors Management
- Stakeholder Management
- Management Control System
- Monitoring & Tracking Project
- Procurement Management
- Project Costing , Budget & Cash Flows
- Detail Supervision
- Quality Assurance
- Management of Professional Contracts & Contract Documents







# Projects in Pakistan

---



# LAHORE 101 TOWER

Located on Jail Road, Lahore facing Golf Club, 101 Tower is a high rise office building with height of 300 feet. It comprises 3 basements, ground floor and 22 floors above with approximate covered area of 540 000 square feet, including a helipad on the rooftop.

Contrivers has been involved in this project from design stage through to the construction phase.

The building features a unique architectural, structural, and MEP design making it one of the most challenging project to manage from concept to completion.





# ISLAMABAD CAPITAL TOWER

Located on Main Jinnah Avenue, Blue Area, Islamabad, Capital Tower is a high rise office building standing at a height of 325 feet. It consists of 4 basements, ground floor, two retail floors and 22 office floors with approximate covered area of 360 000 square feet including a helipad on the rooftop.

As the first high rise building visible from Constitution Avenue, Capital Tower boasts an elegant appearance and a distinctive façade design making it one of the landmark development projects in capital of Pakistan.





# LAHORE QUBE

QUBE is mixed use development featuring banquet halls, commercial offices, health club, and future residential apartment tower. The total covered area of project is approximately 515,000 square feet.

Located in Divine Gardens, Lahore, adjacent to the airport, the project spans total area of 56 kanals out of which 26 kanals are allocated for buildings, while remaining area is designated for a front facing park.





# ISLAMABAD ONE CONSTITUTION AVENUE

One Constitution Avenue, Islamabad is a landmark mixed-use development with a total planned covered area of approximately 3 million square feet. The project includes residential towers, shopping mall, and five-star hotel.

The hotel tower is planned to rise to a height of 750 feet with 51 stories. The residential towers are completed with 26 stories each while the shopping mall currently under construction.





# FATEH JUNG GRAND SHIKHAR RESORT & PARKS

Hunting Resort located at Fateh Jang with area of 3000 acres has 22 natural lakes and 100 Chalets to be build around one of the lakes in Phase 1 with recreational facilities and parks planned in Phase 2.

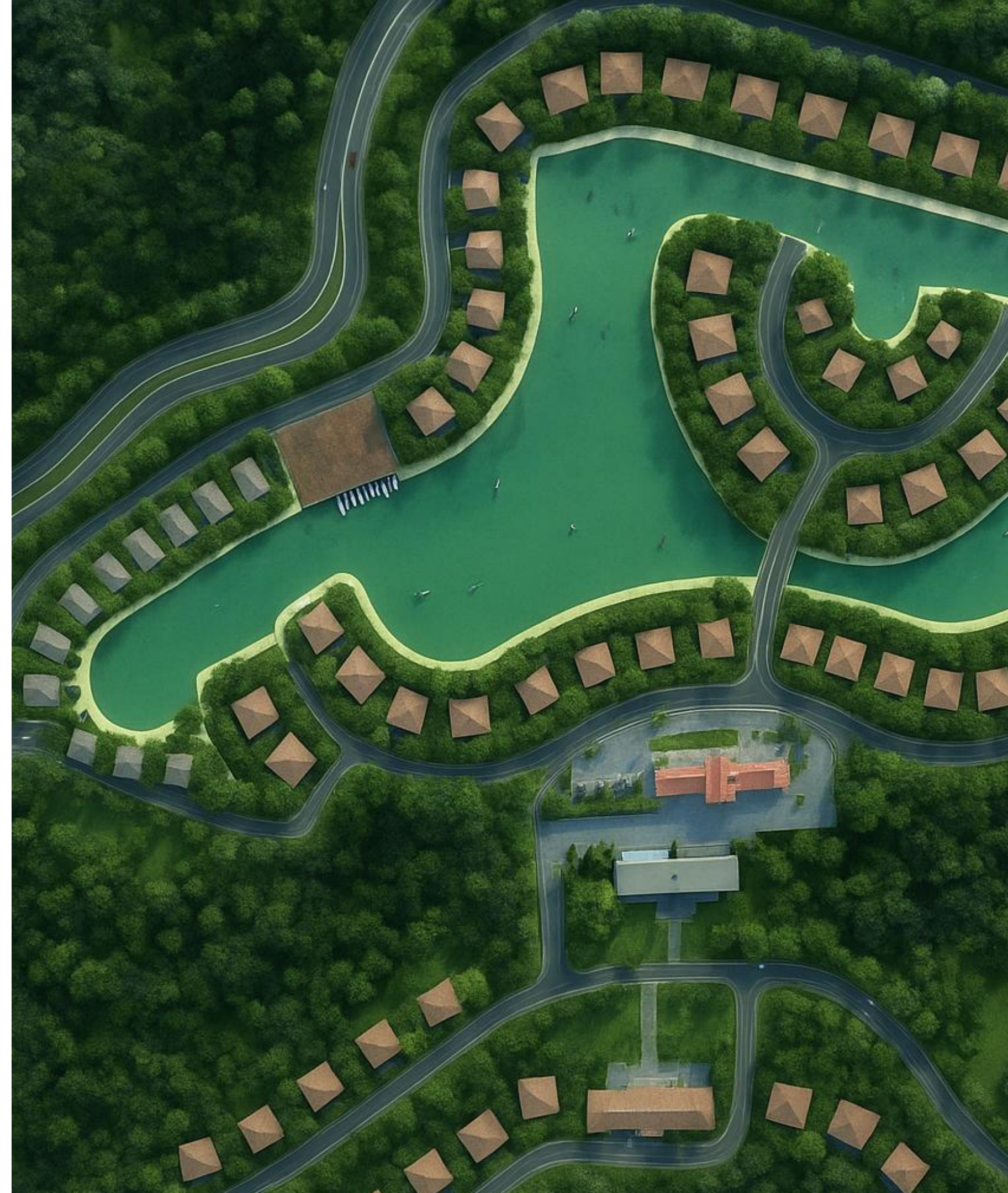



# LAHORE RAYA OFFICE

Client's corporate office with amalgamation of two buildings having total of Six Floors completed with Architectural, MEP & Interiors located at Defense Raya Lahore.





# LAHORE SHEIKHUPURA FAISALABAD **DISTRICT ONE**

Horizontal development ,well planned gated communities with modern infrastructure and amenities located in three different cities having commercial buildings , town houses , Villas & Homes

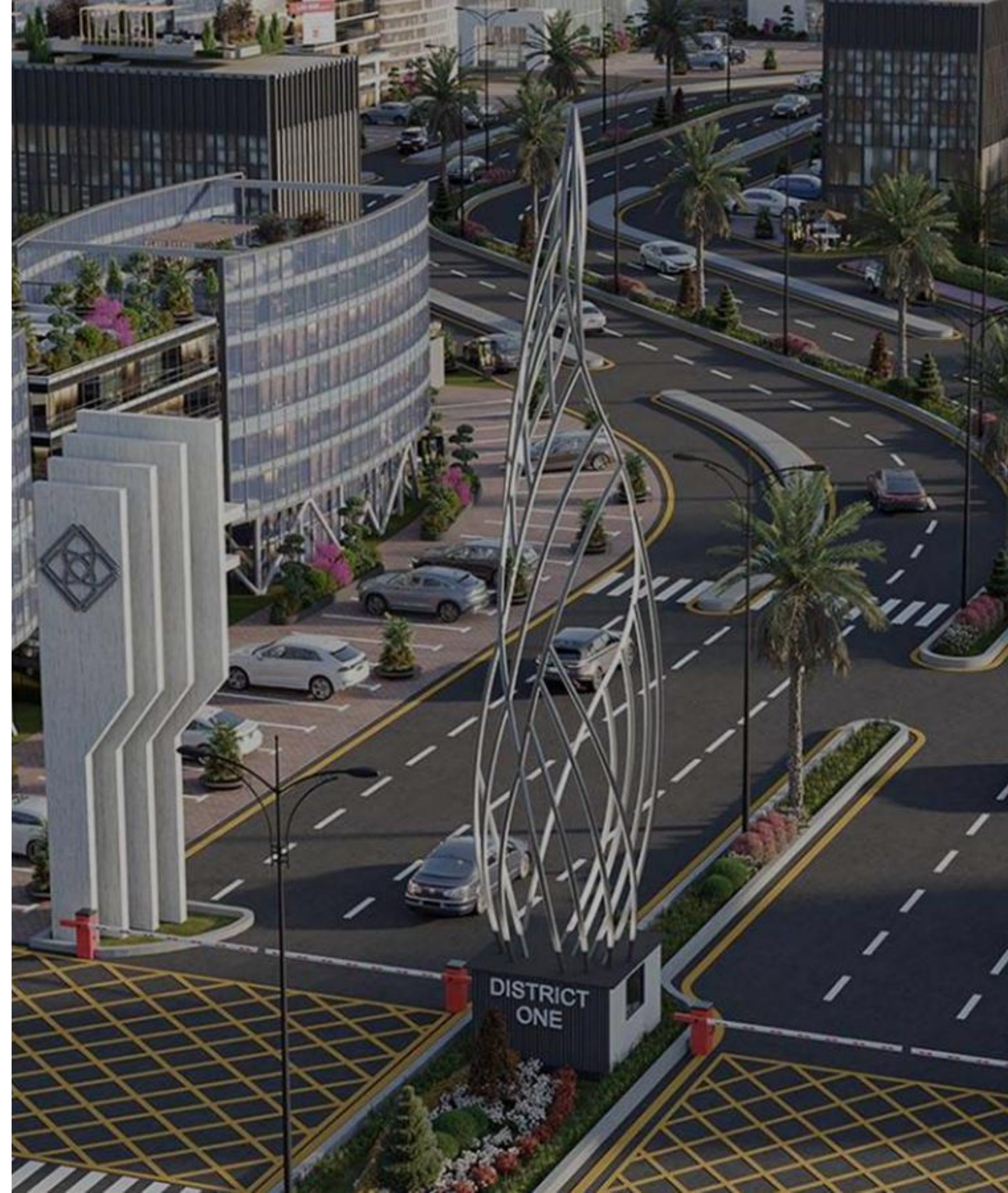





# Projects in Dubai

---



# DUBAI LA VUE | NAD AL SHEBA

Project built up area is 114 000 Sft with Ground Two Podiums Six Apartment Floors above. This project is refined collection of residences in Nad Al Sheba Gardens where thoughtful design meets tranquil views and timeless depth.

With very high end finishes specification, this project will be a timeless product.





# DUBAI LA CLE | AL FURJAN

La Cle is an Apartment Building Project with Built Up area is 156 000 Sft. It has Ground two podium floors Seven Apartment Floors above It's Premium, design led residences in Al Furjan with modern aesthetics and high end finishes.

With it's elegance design of Façade, this will be one of the prominent buildings in Al Furjan area.





# DUBAI CLE 36 | DUBAI SOUTH

Apartment Building Project Modern residences at CLE 36 where smart design meets serene living. Project Built up area is 4 Apartment Floors above.





# DUBAI JVC

JVC is a residential building located in the JVC Dubai. The structure comprises a Ground Floor, a Parking Level, five Residential Floors, and a Rooftop (G+ 5 F+R). Designed for comfortable and modern living, the building offers a mix of contemporary apartments with essential amenities, making it ideal for families and individuals alike.

In this project, we are responsible for Design Coordination only till finalization of Contractor.





# DUBAI PALM VILLA

Complete renovation project with high end design and specifications Project is in construction phase.

In this project, we are responsible for Design Coordination only till finalization of Contractor.





# DUBAI DOWNTOWN

Project located at Dubai Downtown.

Project is at feasibility stage and in process of taking concept approval from Emaar and Design coordination is in progress with Consultants.





# DUBAI CLIENT'S HEAD OFFICE

Client's head office having corporate, sales, marketing & show apartment located at top floor in U-Bora Tower, Business Bay.

One of most high-end, luxurious and top of line design done by Internationally renowned Interior designer with superior quality of finishes & furnishing.







# CEO Experience

---

Working in Project Management Consultant  
Companies & with Employers



# PROJECT: **REHMAN MEDICAL INSTITUTE**

Worked as Director Projects representing a Project Management Consultancy company in construction of two floors in pre-fabricated steel metal structure while the lower floors of hospital were under working conditions.

Other than this, I was involved in design and construction of Dentistry Building of Rehman Medical Institute (RMI) located at Hayatabad, Peshawar.





# PROJECT: **WORLD BANK HEADOFFICE**

Located at Sector F-5 Islamabad , worked as Project Manager in complete renovation and construction of World bank head office and IFC buildings with high end MEP & finishes works.

It was first leed-certified office building in Pakistan having urban forest, specialized windows and HVAC system with world-class material procurement experience.





# PROJECT: **BAKHTAWAR AMIN MEDICAL & DENTAL COLLEGE**

Project Director in Construction of Bakhtawar Amin Medical & Dental College in Multan.





# PROJECT: **FUN CITY**

Project Director in Construction of this high-end Award-Winning indoor kids entertainment facility in Centaurus 2013, Giga Mall 2016 and then renovation in year 2021.





# PROJECT: **CRESCENT BAHUMAN TEXTILE UNITS**

One of the amazing & completely different experience in construction of factory units of Sewing, Cutting & Dyeing Units of Levi's at Crescent Bahuman Pindi Bhattian.

Constructionn of Gable Slab for machinery of dyeing unit, spot cooling, air compressor system and drainage systems were new learning in this extremely fast track project.





# PROJECT: **AMANAH MALL**

Manager Projects in Construction of Amanah Mall located at Model Town link road ,approx. covered area of 450,000 Sft, 4 Basements, Ground & 8 floors above each designed as a separate module for different types of activities. All the basements are designed for ample car parking to serve large number of customers. First four floors (Lower Ground, Ground, First and Second Floor) are for shops that offer an excellent business opportunity to a variety of renowned outlets whereas 3rd, 4th and 5th floors are fixed for Food court, Magic planet Amusement Park, Velocity Health & Fitness club and Cinepax Cinema.

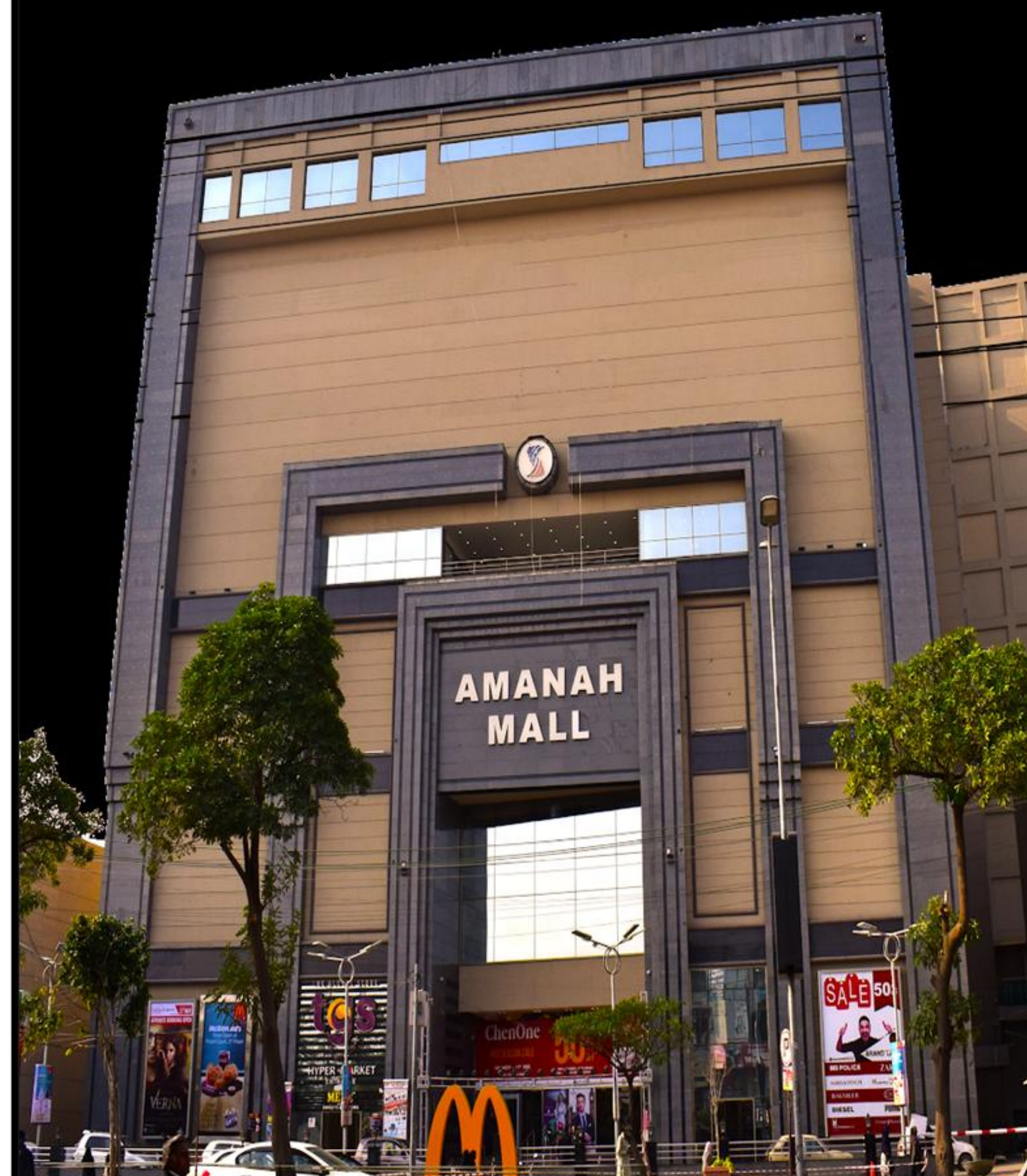



# PROJECT: **STAR MALL & AVARI HOTEL**

Manager Projects in Construction of Star Mall & Avari Hotel Gujranwala.

From Design till Construction and coordination with hotel chain this project was mixed use facility having covered area of approx 350,000 Sqft.





# PROJECT:

## **SONA TOWER (FFC HEAD OFFICE)**

One of most elegant office buildings in Rawalpindi situated at Mall Road Rawalpindi in front of GHQ. It was built as one of the most advanced building of that time with high end automation and advance technologies were used in MEP, IT & systems.

Worked as Manager Planning while working in consultancy company, have done Value Engineering as well in Façade, Traffic Flow & Systems.





# PROJECT: **MARGALA HOTEL**

Worked as a Manager Projects in construction of 40 rooms with public spaces of this Margalla Hotel Project located at M2 near Convention Center Islamabad with complete finishing and furnishing works.





# PROJECT:

## ESSEM INTERCONTINENTAL HOTEL

Situated at Sector F-5/1 Ataturk Avenue Islamabad. Worked as Planning Engineer and then Assistant Resident Engineer on this high-end five star hotel and shopping mall project from 2005 to 2008. Have coordinated complete design from very complex structure till high-end interior design with international design consultants, hotel chain and renowned local consultants . Project foot print is 20,000 Sft, one basement, ground and 11 story above with covered area approx. 600,000 Sft.





# PROJECT: **BAHRIA UNIVERSITY**

My first job as a Planning Engineer on this esteemed project having covered area of approx 300,000 Sft, upto date modern facility comparable to any international university of that time.

This project was my first learning base from year 2002 to 2004 where two of my seniors & mentors, Mr Shahzad Qureshi (Resident Engineer) Mr Shahzad Aslam (Assistant Resident Engineer) have guided me a lot in establishing my carrier ahead.





# CONTRIVERS THANK YOU.



+92 321 5174198



contrivers.com.pk



+ 92 51 5916540



contrivers@contrivers.pk

Office No 2, 4th Floor, ACE Plaza, Eucalyptus Road , DHA II, Islamabad